

JUNTA FIJA MERCEDES

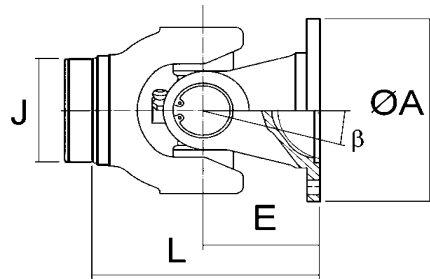

FIG. 1

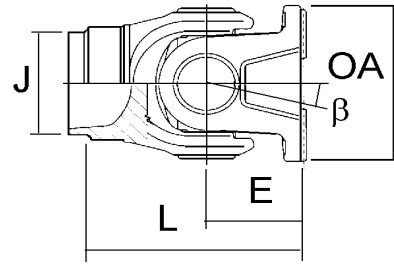
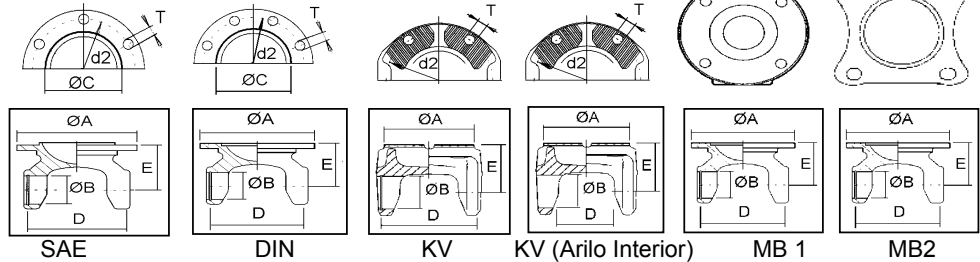

FIG. 2

TIPOS DE ACOPLAMIENTO



| REF. Cardyfen | CRUZ | | SERIE | FIG. | L | Ø J | TIPO | Ø A | N°T | Ø T | Ø C | E | d2 | β | PARA TUBO | OBSERV. | EQUIV. | | | | | |
|------------------|------|-------|-------|------|-----|------|------|-----|-----|-----|-------|-----|-------|-----|-----------|--------------------|--------|---------------|--|--|--|--|
| | Ø B | D | | | | | | | | | | | | | | | | | | | | |
| MBSP 2001 | 27 | 74 | | | | | MB 1 | 120 | 4 | 10 | | | | | 70x2 | MB Sprinter | MB | 901 410 A106 | | | | |
| MBSP 2002 | 27 | 88 | | | | | MB 2 | 135 | 4 | 10 | | | | | 70x2 | Nueva SPRINTER | MB | | | | | |
| 0053 2001 16 | 35 | 96,8 | 0053 | 1 | 135 | 64,4 | SAE | 120 | 6 | 10 | 82,5 | 70 | 101,5 | 35° | 70 x 3 | Encaje macho | MB | 3170-53-05/03 | | | | |
| 0063 2001 12 | 42 | 104,5 | 0063 | 1 | 155 | 73,4 | SAE | 130 | 8 | 10 | 82,5 | 80 | 112 | 35° | 80 x 4 | Encaje macho | MB | 3170-63-04/03 | | | | |
| 2833 2001 01 | 48 | 126 | 2833 | 1 | 176 | 82,1 | DIN | 150 | 8 | 12 | 90 | 75 | 130 | 20° | 90 x 4 | | | 286.33 | | | | |
| 2833 2001 03 | 48 | 126 | 2833 | 1 | 191 | 82,1 | DIN | 180 | 8 | 14 | 110 | 90 | 155,5 | 25° | 90 x 4 | | | 286.33 | | | | |
| 2833 2001 02 | 48 | 126 | 2833 | 1 | 176 | 82,1 | KV | 154 | 4 | 13 | KV70° | 75 | 130 | 25° | 90 x 4 | | | 286.33 | | | | |
| 2837 2001 01 | 53 | 135 | 2837 | 1 | 202 | 90,3 | DIN | 150 | 8 | 12 | 90 | 86 | 130 | 25° | 100 x 5 | | | 286.37 | | | | |
| 2837 2001 02 | 53 | 135 | 2837 | 1 | 202 | 90,3 | DIN | 150 | 12 | 12 | 90 | 86 | 130 | 25° | 100 x 5 | | | 286.37 | | | | |
| 2837 2001 03 | 53 | 135 | 2837 | 1 | 202 | 90,3 | DIN | 165 | 8 | 16 | 95 | 86 | 140 | 25° | 100 x 5 | | | 286.37 | | | | |
| 2837 2001 04 | 53 | 135 | 2837 | 1 | 213 | 90,3 | DIN | 180 | 8 | 12 | 110 | 97 | 155,5 | 25° | 100 x 5 | | | 286.37 | | | | |
| 2837 2001 05 | 53 | 135 | 2837 | 1 | 213 | 90,3 | DIN | 180 | 8 | 14 | 110 | 97 | 155,5 | 25° | 100 x 5 | | | 286.37 | | | | |
| 2837 2001 09 | 53 | 135 | 2837 | 1 | 202 | 90,3 | DIN | 180 | 10 | 16 | 110 | 86 | 155,5 | 25° | 100 x 5 | | | 286.37 | | | | |
| 2837 2001 06 | 53 | 135 | 2837 | 1 | 206 | 90,3 | KV | 150 | 4 | 13 | KV70° | 90 | 130 | 25° | 100 x 5 | | | 286.37 | | | | |
| 2837 2001 07 | 53 | 135 | 2837 | 1 | 213 | 90,3 | KV | 165 | 4 | 13 | KV70° | 97 | 140 | 25° | 100 x 5 | | | 286.37 | | | | |
| 2837 2001 10 | 53 | 135 | 2837 | 1 | 206 | 90,3 | KV | 180 | 4 | 15 | KV70° | 90 | 150 | 25° | 100 x 5 | | | 286.37 | | | | |
| 3860 2002 01 | 68 | 89 | 3860 | 2 | 225 | 98,1 | KV | 180 | 4 | 15 | KV70° | 100 | 150 | 22° | 110 x 6 | Cruz clip interior | | 385.60 | | | | |
| 3860 2001 01 | 68 | 89 | 3860 | 2 | 245 | 130 | KV | 180 | 4 | 15 | KV70° | 100 | 150 | 22° | 140 x 5 | Cruz clip interior | | 385.60 | | | | |
| 0079 2001 01 | 68 | 117 | 0079 | 2 | 253 | 132 | KV | 200 | 4 | 15 | KV70° | 113 | 165 | 22° | 144 x 7 | Cruz clip interior | | 79 | | | | |