

# TRANSMISIONES JOHN DEERE

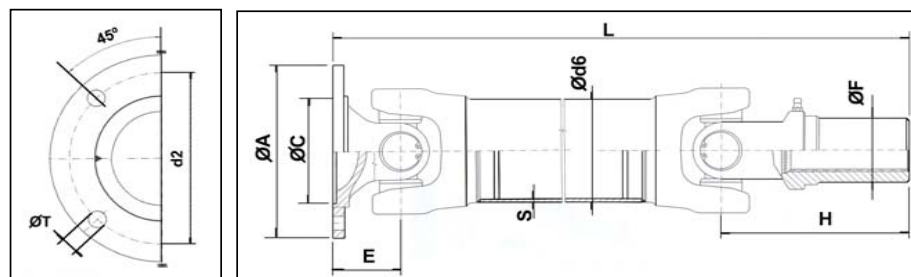

REF. Cardyfren	PARA CRUZ		SERIE	FIG.	L	Ø A	N°T	Ø T	ØC	E	d2	H	Ø F	ESTRIADO	TUBO Ød6 x S	OBSERV.		
	Ø B	D																
0053 314790-15-02	35	96,85	53		661	150	4	12	90	56	124	143,5	60	z=17/ 37x2x30	90 x 2,5			AL115237
0053 314790-14-02	35	96,85	53		703	150	4	12	90	56	124	143,5	60	z=17/ 37x2x30	90 x 2,5			AL114147
0053 314790-11-02	35	96,85	53		1735	150	4	12	90	56	124	143,5	60	z=17/ 37x2x30	90 x 2,5			AL111287 (AL81418)
0053 314790-10-02	35	96,85	53		1803	150	4	12	90	56	124	143,5	60	z=17/ 37x2x30	90 x 2,5			AL111283 (AL81419)
0053 314790-07-02	35	96,85	53		1585	150	4	12	90	56	124	143,5	60	z=17/ 37x2x30	90 x 2,5			AL111359

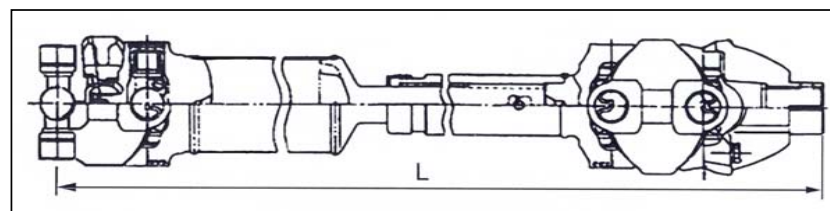

FIG. 2

REF. Cardyfren	PARA CRUZ		SERIE	FIG.	Lz											OBSERV.		
	Ø B	D																
909 532 0111	27	81,8	1310		468													AT 49124
909 532 0411	27	81,8	1310		544													AT 76644
909 532 0521	27	81,8	1310		577													AT 51688
914 153 0417	27	92	1330	2	620													AT 83588 (23X12200C)
914 153 0517	27	92	1330		645													AT 83601